

Radiant 3000

USER MANUAL

CONTENTS

1.SAFETY INFORMATION.....	01
2.DIMENSION	02
3. CONTROL.....	03
4. FIXTURE SPECIFICATION	04
4.1 TECHNICAL DATASHEET	05
4.2 PHOTOMETRICS	05
5.MENU	06
6. INSTALLATION AND CONNECTION	09
6.1 INSTALLATION INSTRUCTION	09
6.2 POWER CONNECTION.....	11
6.3 ARTNET CONNECTION.....	12
6.4 DMX CONNECTION	12
7.DMX CHART.....	14
8.TROUBLESHOOTING	24
9.MAINTENANCE	25
10.EXPLODE DIAGRAM.....	26

1. SAFETY INFORMATION



WARNING! Before carrying out any operations with the unit, carefully read this instruction manual and keep it with care for future reference, it contains important information about the installation, user and maintenance of the unit.

GENERAL INSTRUCTION

- The products referred to in this manual conform to the European Community Directives and are therefore marked with CE.
- The unit is supplied with hazardous network voltage (230V~). Service should be undertaken by skilled personnel only. Never make any modifications on the unit not described in this instruction manual, otherwise you will risk an electric shock.
- Connection must be made to power supply system fitted with efficient earthing (Class I appliance according to standard EN60598-1). It is recommended to protect the supply lines of the units from indirect contact and/or shorting to earth by using appropriately sized residual current devices.
- The connection to the main network of electric distribution must be carried out by a qualified electrical installer. Check that the main frequency and voltage correspond to those for which the unit is designed as given on the electrical data label.
- This unit is not for home use, only professional applications.
- Never use the fixture under the following conditions:
 - in places subject to vibrations or bumps;
 - in place with a temperature of over 40°C.
- Make certain that no Flammable liquids, water or metal objects enter the fixture.
- Do not dismantle or modify the fixture.
- All work must always be carried out by qualified technical personnel. Contact the nearest sales point for an inspection or contact the manufacturer directly.
- If the unit is to be put out of operation definitively, ensure you dispose of the unit responsibly in accordance with local recycling laws.



WARNINGS AND INSTALLATION PRECAUTIONS

- If this device will be operated in any way different to the one described in this manual, it may suffer damage and the guarantee becomes void. Furthermore, any operation may lead to dangers like short circuit, burns, electric shock, etc.
- Before starting any maintenance work or cleaning the fixture, cut off power from the main supply.
- Always additionally secure the fixture with the safety rope. When carrying out any work, always comply scrupulously with all the regulations (particularly regarding safety) currently in force in the country in which the fixture's being used.
- Install the fixture in a well ventilated place.
- Keep any Flammable materials at a safe distance from the fixture.
- Shields, lenses or ultraviolet screens shall be changed if they have become damaged to such an extent that their effectiveness is impaired.
- The lamp (LED) shall be changed if it has become damaged or thermally deformed.
- Never look directly at the light beam. Please note that fast changes in lighting, e.g. flashing light, may trigger epileptic seizures in photosensitive persons or persons with epilepsy.
- Do not touch the product's housing when operating because it may be very hot.

2.DIMENSION

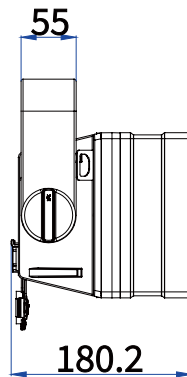
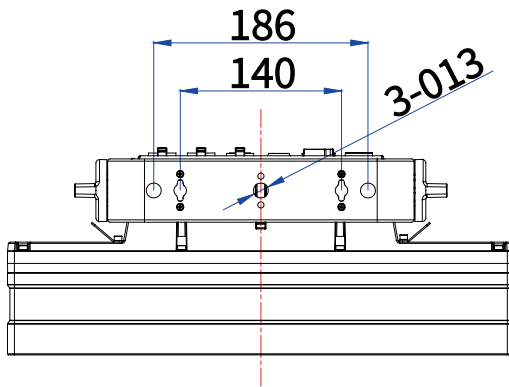
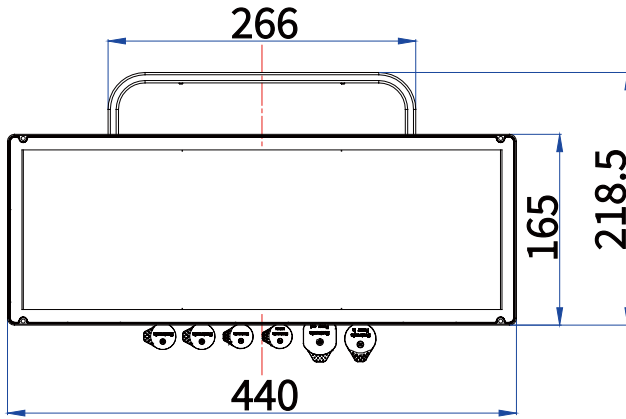

3.CONTROL

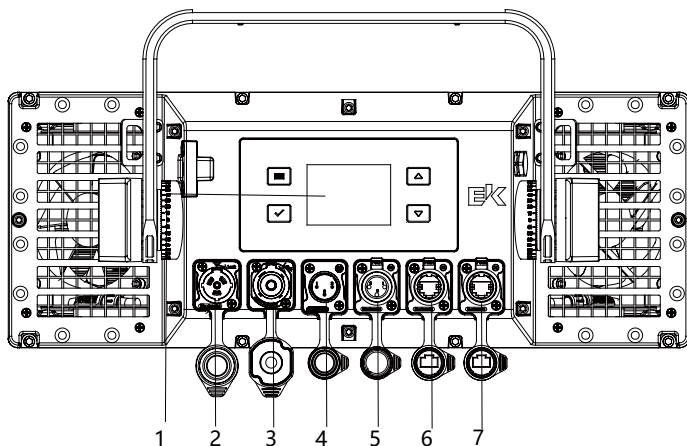

1. Display

2. Power In

3. Power Out

4. DMX Int

5. DMX Out

6/7. Artnet port

Menu Display

Function	Illustration	Description	Function
MODE (Left)	Menu Option	Enter Menu	Menu Operation
UP	UP	Scroll Up	Increase Numeric Value
DOWN	DOWN	Scroll Down	Decrease Numeric Value
ENTER (Right)	Confirm	Confirm	Save Setting

If you want to flip the display, hold UP + DOWN buttons for 3seconds to set display orientation.
 Without external power source, long press the right button for 3 seconds, enter the menu to set parameters.

4. FIXTURE SPECIFICATION

4.1 TECHNICAL DATASHEET

PHOTOMETRICS	
Light Source	RGBW 4-in-1 LED 5W*720PCS
Color Temperature	2800K ~ 10000K
Luminous flux(Lm)	R:24200LM G:51000LM B:8600LM W:60000LM ALL:45700LM Peak value ALL:210000LM
Illuminance(Lux)	ALL:800Lux@5m
Wave length	R:624nm G:527nm B:455nm
CRI	Ra ≥ 90, R9 ≥ 90
Beam Angle	112°
Pan-Beam Angle	158°
Life Span	30000H
FEATURES	
Color System	RGBW
Strobe	1 ~ 30Hz
Dimming	0 ~ 100% linear dimming
CONTROL	
Protocol	DMX512/RDM/sACN/Artnet
DMX Channel	4CH/ 5CH/ 240CH/ 11CH /247CH /151CH /127CH /79CH /55CH /31CH / 27CH /23CH /19CH /11CH / 19CH / 255CH /31CH/267CH
Data Connections	Seetronic XLR In/Out, Seetronic ArtNet In/Out, linking up to 32pcs
Display	240RGB*320 2.8-inch TFT display
Frequency	1KHz/2KHz/4KHz/6KHz/25KHz
Built-in programs	Yes
Pixel Matrix	12*5
POWER	
Mains	100 ~ 240V,50/60Hz
Consumption	Static:230V@985W;Strobe Peak:230V@ 3400W
Power connections	TrueCon In/Out, linking up to 2pcs@230V
Ambient	-10 ~ 45°C
Power Supply	AC 100~240VAC (50/60HZ), 1200W
PHYSICAL	
Size	440*180.2*218.5mm
Weight	9.4Kg
IP rating	IP66
Cooling	Aluminum alloy heat sink with low noise fan
Housing	Magnesium alloy, matte black finish
ACCESSORY	
Standard	Power cord
Optional	floor stand, diffuser, matte black diffuser, 2-cell interlock, 4-cell interlock, barn door, safety rope, DMX cable

4.2 Photometrics

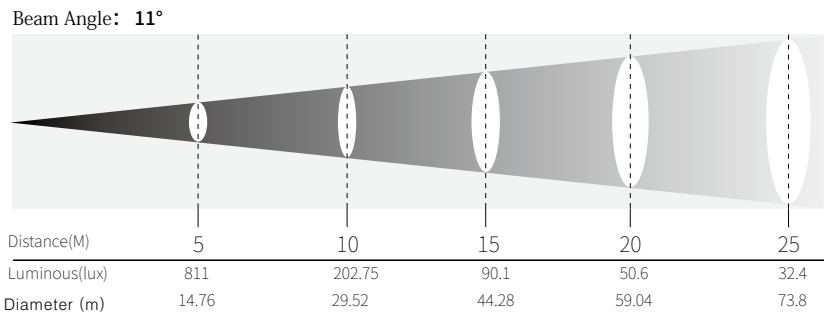

5.MENU

\	Main Menu	Menu level 2	Menu level 3	Menu level 4	Remark		
1	DMX Setting	DMX Address	1~512				
		DMX Channel	Basic	STATIC			
				STROBE	R=0~255		
					G=0~255		
					B=0~255		
					W=0~255		
				PIXEL			
			RGBW STROBE				
			Pixels	PIXELS60			
				PIXELS30			
				PIXELS36			
				PIXELS18			
				PIXELS12			
		PIXELS3					
		PIXELS12 2					
		PIXELS5					
		PIXELS6					
		PIXELS4					
		Advanced	PIXELS3 2				
			PIXELS 1				
ADVANCED 1							
ADVANCED 2							
2	Protocol	DMX					
		Artnet					
		sACN					
		Artnet+DMX					
		sACN+DMX					
3	Ethernet Setting	IP Address	xxx.xxx.xxx.xxx				
		Artnet Setting	Net	0-127			
			Subnet	0-15			
			Universe	0-15			
		sACN Universe	1-63999				
		Start Address	1-512				
		Net To DMX	Off				
On							

\	Main Menu	Menu level 2	Menu level 3	Menu level 4	Remark
4	Stand Alone	Color Macros	Fixed Color	R	
				G	
				B	
				W	
				GB	
				RB	
				RG	
				RW	
				GW	
				BW	
				RGB	
				RGW	
				RBW	
				GBW	
				RGBW	
			Color Temperature	2800K	
				3000K	
				3200K	
				3500K	
				4000K	
				4500K	
				5000K	
				5600K	
				6000K	
				6500K	
				7000K	
				7500K	
				8000K	
				8500K	
				9000K	
			9500K		
			10000K		
			Manual Color	Red	0~255
		Green		0~255	
		Blue		0~255	
		White		0~255	
		Auto Show	Show 1	Speed	1~100
			Show 2		
			Show 3		
			Show 4		
			Show 5		
			Show 6		
			Show 7		
Show 8	BLACK R G B W GB RB RG RW GW BW RGB RGW RBW GBW RGBW				
Show 9					
Show 10					
Show 11					
Show 12					
Show 13					
Show 14					
Show 15					
Show 16					
Show 17					
Show 18					
Show 19					
Show 20					
Show 21					
Show 22					
Show 23					
5	Master/Slave	Slave			
		Master			

\	Main Menu	Menu level 2	Menu level 3	Menu level 4	Remark
6	Settings	Dimmer Setting	Dimmer Mode	Off	
				Dimmer 1	
				Dimmer 2	
				Dimmer 3	
			Auto		
			Dimmer Curve	S Curve	
				Linear	
				Square	
		Inverse Square			
		LED Setting	LED Frequency	1000Hz	
				2000Hz	
				4000Hz	
				6000Hz	
				25KHz	
		Invert Mapping	No		
			Yes		
		Fan Mode	Auto		
			On		
			Off		
			Silent		
		Display Setting	Back Light	30S	
On					
Flip Display	No				
	Yes				
	Auto				
Key Lock	No				
	Yes				
7	Advanced	Code:xxx	Color Calibration	User Calibration	Red 125~255
					Green 125~255
					Blue 125~255
					White 125~255
		Factory Reset	No		
			Yes		
8	Information	Fixture Hours	0~65535H		
		Led Hours	0~65535H		
		Version	DISP-V1.x		
			DRV-V1.x		
		Temperature	LED1: 40°C		
				
			LED12: 40°C		
		Fan Speed	xxx%		
		UID:	*****		

6. INSTALLATION AND CONNECTION

6.1 INSTALLATION INSTRUCTION

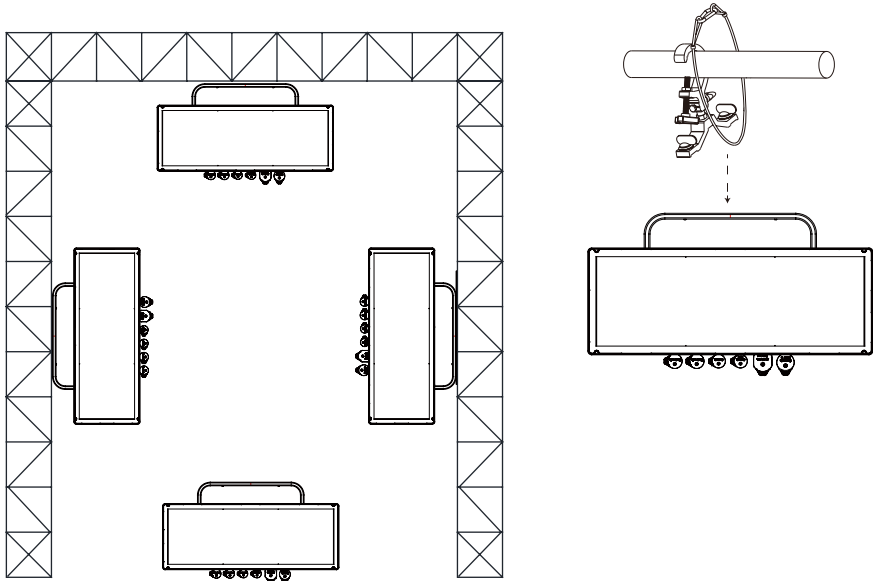

1. Professional installation required. Mount away from walkways, seating areas, or unauthorized access.
2. Never stand directly beneath the fixture during assembly, disassembly, or maintenance.
3. Ensure secure mounting to prevent vibration or slippage during operation.
4. The supporting structure must withstand 10x the fixture's weight without deformation. Always use a safety cable rated for 12x the fixture's weight to prevent falls if the clamp fails.
5. Operational in two positions: Sit-flat floor mounting and flown mounting.
6. Radiant 3000 is IP66 (indoor & Outdoor use), ensuring: Dustproof – Prevents dust ingress, so that it will not interfere with its normal operation. Water-resistant – Protects against water jets from any direction.

FLOWN MOUNTING

1. During installation, maintain a minimum distance of 0.5 meters between the fixture and any flammable materials .
2. When flown mounting, a safety cable rated for at least 10 times the fixture's weight must be installed.
3. For overhead mounting, the supporting structure must have a load capacity of at least 10 times the fixture's weight.
4. As shown in the diagram, the safety cable must pass through both the fixture's safety cable eyelet and the mounting structure to ensure a secure connection.

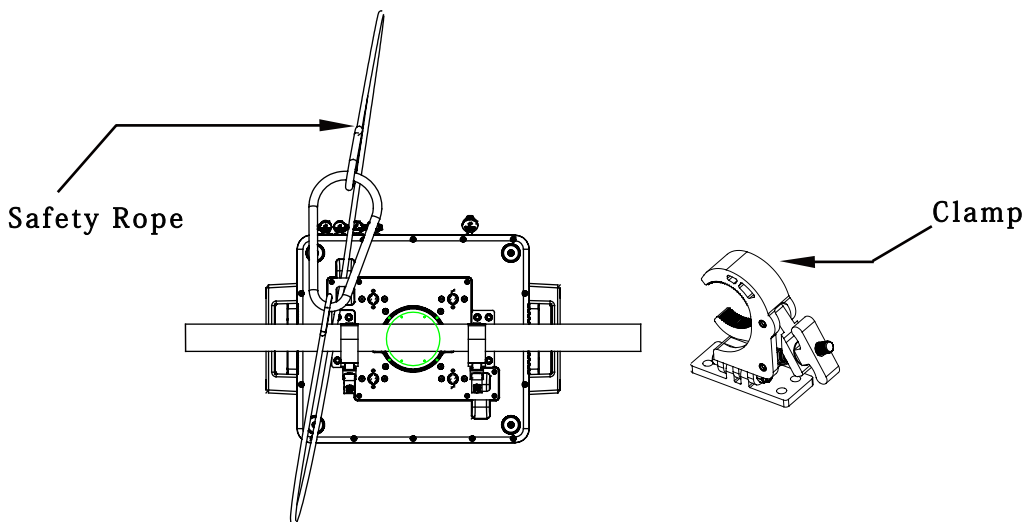

6.2 POWER CONNECTION

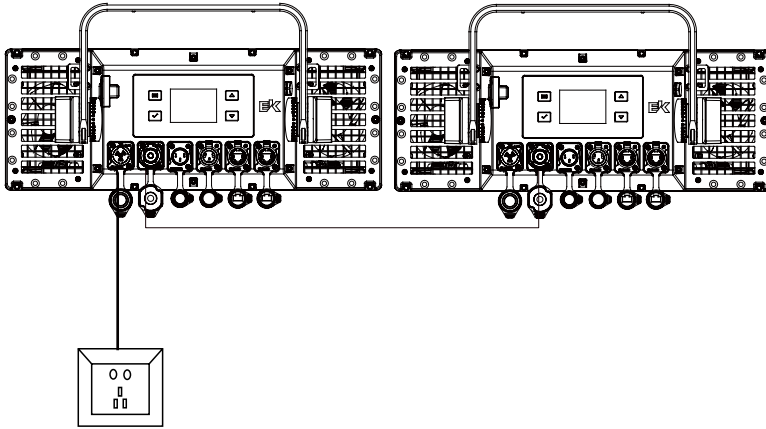

POWER CONNECTION INSTRUCTION



Power In



Power out

Notes: For power reasons, using 1.5mm² power cable can link up to 2 units (230V) maximum.



WARNING

Do not connect more than 2 units with one power cable, or overload the work.

Do not use the power cable if the insulation layer has been damaged. Do not put the power cable on other wires. When not in use or clean, please remove the power cable.

Do not vigorously plug in or drag the power cable.

6.3 ARTNET CONNECTION

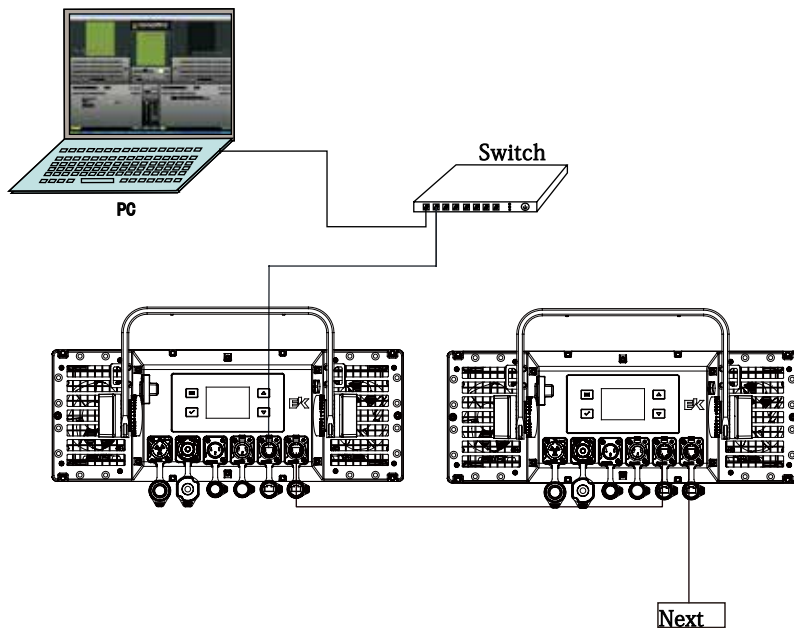

6.4 DMX CONNECTION

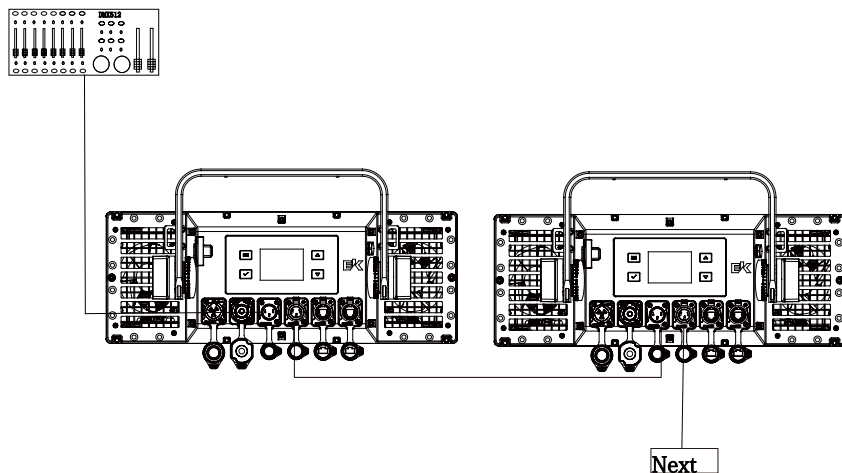

DMX CONNECTION

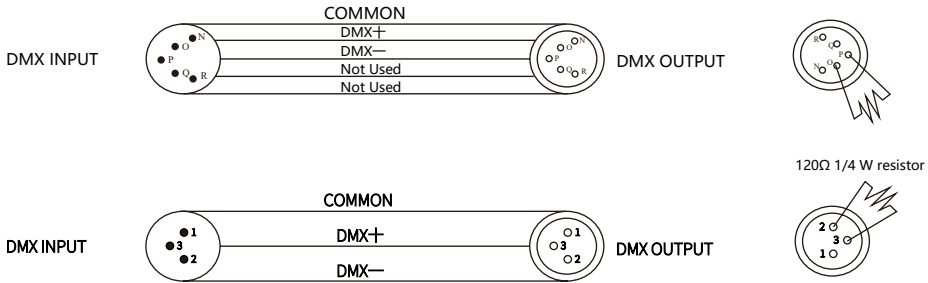

- To minimize signal errors and prevent signal degradation/interference, connect a 120 Ω 1/4W resistor between 2 pins and 3 pins at the last fixture's DMX output.
- Use XLR cables to link fixtures - connect from the output of one fixture to the input of the next. DMX must be wired in series, not parallel.
- Signal integrity is critical due to DMX512's high speed. Damaged cables, poor solder joints, or loose connections can disrupt transmission and cause system failure.
- The DMX connection is bypassed when a unit loses power to maintain signal continuity.
- Each fixture requires a unique address to receive console commands.
- Always install a terminator at the end of the DMX512 chain to reduce transmission errors.

RELATION BETWEEN DMX AND ADDRESS

Mode	Address	1ST FIXTURE	2ND FIXTURE	3RD FIXTURE
ADVANCED 1	001 –015	001	016	031
ADVANCED 2	001 –251	001	252	503
ADVANCED 3	001 –027	001	028	055
ADVANCED 4	001 –263	001	264	

7. DMX CHART

BASIC - STATIC				
Channel	Function	Value	Percent/Setting	Remark
1	Red	000-255	Red intensity	
2	Green	000-255	Green intensity	
3	Blue	000-255	Blue intensity	
4	White	000-255	White intensity	
BASIC - STROBE (color could be choosed by menu)				
Channel	Function	Value	Percent/Setting	Remark
1	DIMMER	000-255	Minimum to maximum	
2	DIMMER FINE	000-255	Minimum to maximum	
3	FLASH DURATION	000-255	15ms-990ms	
4	FLASH RATE	000-010	No Flash	
		011-255	Strobe slow to fast	
5	FLASH FX	000-002	No Effect	
		003-005	Static	If selected, the fixture will works as wash, only dimmer control.
		006-042	Ramp up	
		043-085	Ramp down	
		086-128	Ramp up-down	
		129-171	Random	
		172-214	Lightning	
		215-255	Spikes	
BASIC - PIXEL				
Channel	Function	Value	Percent/Setting	Remark
1	PIXEL 1 RED	000-255	Red intensity	
2	PIXEL 1 GREEN	000-255	Green intensity	
3	PIXEL 1 BLUE	000-255	Blue intensity	
4	PIXEL 1 WHITE	000-255	White intensity	
	...			
237	PIXEL 60 RED	000-255	Red intensity	
238	PIXEL 60 GREEN	000-255	Green intensity	
239	PIXEL 60 BLUE	000-255	Blue intensity	
240	PIXEL 60 WHITE	000-255	White intensity	
BASIC - RGBW STROBE				
Channel	Function	Value	Percent/Setting	Remark
1	RED	000-255	Red intensity	
2	GREEN	000-255	Green intensity	
3	BLUE	000-255	Blue intensity	
4	WHITE	000-255	White intensity	
5	CCT	000-255	Color Temperature	
6	TINT	000-255		
7	DIMMER	000-255	Minimum to maximum	
8	DIMMER FINE	000-255	Minimum to maximum	
9	FLASH DURATION	000-255	15ms-990ms	
10	FLASH RATE	000-010	No Flash	
		011-255	Strobe slow to fast	
11	FLASH FX	000-002	No Effect	
		003-005	Static	If selected, works as wash, only dimmer and color control.
		006-042	Ramp up	
		043-085	Ramp down	
		086-128	Ramp up-down	
		129-171	Random	
		172-214	Lightning	
		215-255	Spikes	

PIXELS - PIXELS

PIXEL MODE	DMX		Art-net+DMX		Function	Value	Percent/Setting	Remark
	Artnet		Artnet	DMX				
1	1	/	1		DIMMER	000-255	Minimum to maximum	
	2	/	2		DIMMER FINE	000-255	Minimum to maximum	
	3	/	3		FLASH DURATION	000-255	15ms-990ms	
	4	/	4		FLASH RATE	000-010	No Flash	Single flash with ch 1
						011-255	Strobe slow to fast	
						000-002	No Effect	
	5	/	5		FLASH FX	003-005	Static	If selected, the fixture will work as wash, only dimmer control.
						006-042	Ramp up	
						043-085	Ramp down	
						086-128	Ramp up-down	
						129-171	Random	
172-214						Lightning		
215-255						Spikes		
6	/	6		CCT	000-255	Color Temperature		
7	/	7		TINT	000-255			
8	1	/		PIXEL 1	RED	000-255	Red intensity	
					GREEN	000-255	Green intensity	
					BLUE	000-255	Blue intensity	
					WHITE	000-255	White intensity	
					9	2	/	
10	3	/						
11	4	/						
3	12	5	/	PIXEL 3	RED	000-255	Red intensity	
					GREEN	000-255	Green intensity	
					BLUE	000-255	Blue intensity	
					WHITE	000-255	White intensity	
					RED	000-255	Red intensity	
					GREEN	000-255	Green intensity	
					BLUE	000-255	Blue intensity	
					WHITE	000-255	White intensity	
					17	10	/	
18	11	/						
19	12	/						
4	20	13	/	PIXEL 4	RED	000-255	Red intensity	
					GREEN	000-255	Green intensity	
					BLUE	000-255	Blue intensity	
					WHITE	000-255	White intensity	
5	24	17	/	PIXEL 5	RED	000-255	Red intensity	
					GREEN	000-255	Green intensity	
					BLUE	000-255	Blue intensity	
					WHITE	000-255	White intensity	
6	28	21	/	PIXEL 6	RED	000-255	Red intensity	
					GREEN	000-255	Green intensity	
					BLUE	000-255	Blue intensity	
					WHITE	000-255	White intensity	
					31	24	/	
...	...							
12	52	45	/	PIXEL 12	RED	000-255	Red intensity	
					GREEN	000-255	Green intensity	
					BLUE	000-255	Blue intensity	
					WHITE	000-255	White intensity	
...	...							
18	76	69	/	PIXEL 18	RED	000-255	Red intensity	
					GREEN	000-255	Green intensity	
					BLUE	000-255	Blue intensity	
					WHITE	000-255	White intensity	
...	...							
30	124	117	/	PIXEL 30	RED	000-255	Red intensity	
					GREEN	000-255	Green intensity	
					BLUE	000-255	Blue intensity	
					WHITE	000-255	White intensity	
...	...							
36	148	141	/	PIXEL 36	RED	000-255	Red intensity	
					GREEN	000-255	Green intensity	
					BLUE	000-255	Blue intensity	
					WHITE	000-255	White intensity	
...	...							
60	244	237	/	PIXEL 60	RED	000-255	Red intensity	
					GREEN	000-255	Green intensity	
					BLUE	000-255	Blue intensity	
					WHITE	000-255	White intensity	
245	238	/						
246	239	/						
247	240	/						

ADVANCED:

1. Background could be shining only when the foreground is strobing or running an effect.
2. In case both the foreground and background are shining simultaneously, then foreground takes precedence over the background.
3. In case both the first and second layer effects are active simultaneously, the second layer takes precedence.
4. In case the foreground and Layer 1 use the same color, Layer 1 takes precedence. only when Layer 1 does not control the color, then foreground and background can be overlaid. (ADVANCED 3/4)

ADVANCED - ADVANCED 1				
Channel	Function	Value	Percent/Setting	Remark
1	DIMMER	000-255	Minimum to maximum	
2	DIMMER FINE	000-255	Minimum to maximum	
3	FLASH DIMMER	000-255	Strobe dimmer	
4	FLASH STROBE	000-030	No flash/Closed	
		031-100	Strobe slow to fast	
		101-130	Open	
		131-200	Random strobe slow to fast	
		201-255	Open	
5	FLASH RED	000-255	Red intensity	
6	FLASH GREEN	000-255	Green intensity	
7	FLASH BLUE	000-255	Blue intensity	
8	FLASH WHITE	000-255	White intensity	
9	CCT	000-255	Color Temperature	
10	TINT	000-255		
9	BG DIMMER	000-255	Strobe Dimmer	
12	BG STROBE	000-030	No flash/Closed	
		031-100	Strobe slow to fast	
		101-130	Open	
		131-200	Random strobe slow to fast	
		201-255	Open	
13	BG RED	000-255	Red intensity	
14	BG GREEN	000-255	Green intensity	
15	BG BLUE	000-255	Blue intensity	
16	BG WHITE	000-255	White intensity	
17	AUTO FX	000-010	No Function	
		011-015	FX 1	
		016-020	FX 2	
		021-025	FX 3	
		026-030	FX 4	
		031-035	FX 5	
		036-040	FX 6	
		041-045	FX 7	
		046-050	FX 8	
		051-055	FX 9	
		056-060	FX 10	
		061-065	FX 11	
		066-070	FX 12	
		071-075	FX 13	
		076-080	FX 14	
		081-085	FX 15	
		086-090	FX 16	
		091-095	FX 17	
		096-100	FX 18	
		101-105	FX 19	
		106-110	FX 20	
		111-115	FX 21	
		116-120	FX 22	
121-125	FX 23			
126-205	RESERVED(TBD)			
18	FX SPEED	000-050	Static indexing	
		051-255	From slow to fast	From 1 to 10 pixel, 1 more pixel every 5 steps

19	DIMMER MODE	000-042	From MENU	
		043-085	Mode OFF	
		086-128	Mode 1	
		129-171	Mode 2	
		172-214	Mode 3	
		215-255	Mode Auto	

ADVANCED - ADVANCED 2

DMX	Art-net+DMX		Function	Value	Percent/Setting	Remark
Artnet	Artnet	DMX				
1	/	1	DIMMER	000-255	Minimum to maximum	
2	/	2	DIMMER FINE	000-255	Minimum to maximum	
3	/	3	FLASH DIMMER	000-255	0-100%	
4	/	4	FLASH STROBE	000-030	No flash/Closed	
				031-100	Strobe slow to fast	
				101-130	Open	
				131-200	Random strobe slow to fast	
				201-255	Open	
5	/	5	BG DIMMER	000-255	Strobe Dimmer	
6	/	6	BG STROBE	000-030	No flash/Closed	
				031-100	Strobe slow to fast	
				101-130	Open	
				131-200	Random strobe slow to fast	
				201-255	Open	
7	/	7	BG RED	000-255	Red intensity	
8	/	8	BG GREEN	000-255	Green intensity	
9	/	9	BG BLUE	000-255	Blue intensity	
10	/	10	BG WHITE	000-255	White intensity	
11	/	11	AUTO FX	000-010	No Function	
				011-015	FX 1	
				016-020	FX 2	
				021-025	FX 3	
				026-030	FX 4	
				031-035	FX 5	
				036-040	FX 6	
				041-045	FX 7	
				046-050	FX 8	
				051-055	FX 9	
				056-060	FX 10	
				061-065	FX 11	
				066-070	FX 12	
				071-075	FX 13	
				076-080	FX 14	
				081-085	FX 15	
				086-090	FX 16	
				091-095	FX 17	
				096-100	FX 18	
				101-105	FX 19	
				106-110	FX 20	
				111-115	FX 21	
				116-120	FX 22	
121-125	FX 23					
126-205	RESERVED(TBD)					
206-255	Random pixel(with density)	From 1 to 10 pixel, 1 more pixel every 5 steps				
12	/	12	FX SPEED	000-050	Static indexing	
				051-255	From slow to fast	

13	/	13	DIMMER MODE	000-042	From MENU	
				043-085	Mode OFF	
				086-128	Mode 1	
				129-171	Mode 2	
				172-214	Mode 3	
				215-255	Mode Auto	
14	/	14	CCT	000-255	Color Temperature	
15	/	15	TINT	000-255		
16	1	/	PIXEL 1 RED	000-255	Red intensity	
17	2	/	PIXEL 1 GREEN	000-255	Green intensity	
18	3	/	PIXEL 1 BLUE	000-255	Blue intensity	
19	4	/	PIXEL 1 WHITE	000-255	White intensity	
...	...	/	
252	237	/	PIXEL 60 RED	000-255	Red intensity	
253	238	/	PIXEL 60 GREEN	000-255	Green intensity	
254	239	/	PIXEL 60 BLUE	000-255	Blue intensity	
255	240	/	PIXEL 60 WHITE	000-255	White intensity	

ADVANCED - ADVANCED 3						
Channel	BASIC FUNCTION	FUNCTION WITH L2 FX	Value	Setting	WITH FX	Remark
1	DIMMER		000-255	Minimum to maximum		
2	DIMMER FINE		000-255	Minimum to maximum		
3	FLASH DIMMER	LAYER2 DIMMER	000-255	0-100%	Layer 2 dimmer	
4	FLASH STROBE	LAYER2 STROBE	000-030	No flash/Closed	- Same -	No output - Single flash with ch 1
			031-100	Strobe slow to fast	- Same -	
			101-130	Open	- Same -	
			131-200	Random strobe slow to fast	- Same -	
			201-255	Open	- Same -	
5	FLASH RED	LAYER2 RED	000-255	Red intensity	Layer 2 Red	
6	FLASH GREEN	LAYER2 GREEN	000-255	Green intensity	Layer 2 Green	
7	FLASH BLUE	LAYER2 BLUE	000-255	Blue intensity	Layer 2 Blue	
8	FLASH WHITE	LAYER2 WHITE	000-255	White intensity	Layer 2 White	
9	CCT		000-255	Color Temperature		
10	TINT		000-255			
11	BG DIMMER		000-255	Strobe Dimmer		
12	BG STROBE		000-030	No flash/Closed		
			031-100	Strobe slow to fast		
			101-130	Open		
			131-200	Random strobe slow to fast		
			201-255	Open		
13	BG RED		000-255	Red intensity		
14	BG GREEN		000-255	Green intensity		
15	BG BLUE		000-255	Blue intensity		
16	BG WHITE		000-255	White intensity		
17	LAYER1 DIMMER		000-255	Strobe Dimmer		
18	LAYER1 STROBE		000-030	No flash/Closed		
			031-100	Strobe slow to fast		
			101-130	Open		
			131-200	Random strobe slow to fast		
			201-255	Open		
19	LAYER1 RED		000-255	Red intensity		
20	LAYER1 GREEN		000-255	Green intensity		
21	LAYER1 BLUE		000-255	Blue intensity		
22	LAYER1 WHITE		000-255	White intensity		

23	LAYER1 FX	000-010	No Function	
		011-015	FX 1	
		016-020	FX 2	
		021-025	FX 3	
		026-030	FX 4	
		031-035	FX 5	
		036-040	FX 6	
		041-045	FX 7	
		046-050	FX 8	
		051-055	FX 9	
		056-060	FX 10	
		061-065	FX 11	
		066-070	FX 12	
		071-075	FX 13	
		076-080	FX 14	
		081-085	FX 15	
		086-090	FX 16	
		091-095	FX 17	
		096-100	FX 18	
		101-105	FX 19	
		106-110	FX 20	
		111-115	FX 21	
		116-120	FX 22	
121-125	FX 23			
126-205	RESERVED(TBD)			
206-255	Random pixel(with density)	From 1 to 32 pixel, 1 more pixel every 5 steps		
24	LAYER1 FX SPEED	000-050	Static indexing	
		051-255	From slow to fast	
25	LAYER1 FX OFFSET	000 -200	Continuous start selection	Choose the step of start
		201 -255	Random distribution	Enables an internal distribution of the start between a multiple of steps in a specific DMX line based on their DMX starting address.
26	LAYER2 FX	000-010	No Function	
	(Colors and strobe are controlled by FLASH channels.	011-015	FX 1	
	If no FX is selected, the FLASH channels will work as basic function.)	016-020	FX 2	
		021-025	FX 3	
		026-030	FX 4	
		031-035	FX 5	
		036-040	FX 6	
		041-045	FX 7	
		046-050	FX 8	
		051-055	FX 9	
		056-060	FX 10	
		061-065	FX 11	
		066-070	FX 12	
		071-075	FX 13	
		076-080	FX 14	
		081-085	FX 15	
		086-090	FX 16	
		091-095	FX 17	
		096-100	FX 18	
		101-105	FX 19	
	106-110	FX 20		
	111-115	FX 21		
	116-120	FX 22		
	121-125	FX 23		
	126-205	RESERVED(TBD)		
	206-255	Random pixel(with density)	From 1 to 10 pixel, 1 more pixel every 5 steps	
27	LAYER2 FX SPEED	000-050	Static indexing	
		051-255	From slow to fast	

28	LAYER2 FX OFFSET	000-200	Continuous start selection	Choose the step of start
		201-255	Random distribution	Enables an internal distribution of the macro between a multitude of lights on a specific DMX line basing on their DMX starting address.
29	EMPTY	-	TBD	
30	EMPTY	-	TBD	
31	DIMMER MODE	000-042	From MENU	
		043-085	Mode OFF	
		086-128	Mode 1	
		129-171	Mode 2	
		172-214	Mode 3	
		215-255	Mode Auto	

ADVANCED - ADVANCED 4

Artnet	Artnet+DMX		BASIC Function	WITH L2 FX	Value	Setting	WITH FX	Remark
DMX	Artnet	DMX						
1	/	1	DIMMER		000-255	Minimum to maximum		
2	/	2	DIMMER FINE		000-255	Minimum to maximum		
3	/	3	FLASH DIMMER	LAYER2 DIMMER	000-255	0-100%	Layer 2 dimmer	
4	/	4	FLASH STROBE	LAYER2 STROBE	000-030	No flash/Closed	- Same -	
					031-100	Strobe slow to fast	- Same -	
					101-130	Open	- Same -	
					131-200	Random strobe slow to fast	- Same -	
					201-255	Open	- Same -	
5	1	/	FLASH 1 RED	LAYER2 1 RED	000-255	Red intensity	Layer 2 Red	
6	2	/	FLASH 1 GREEN	LAYER2 1 GREEN	000-255	Green intensity	Layer 2 Green	
7	3	/	FLASH 1 BLUE	LAYER2 1 BLUE	000-255	Blue intensity	Layer 2 Blue	
8	4	/	FLASH 1 WHITE	LAYER2 1 WHITE	000-255	White intensity	Layer 2 White	
...	...	/		
241	237	/	FLASH 60 RED	LAYER2 48 RED	000-255	Red intensity	Layer 2 Red	
242	238	/	FLASH 60 GREEN	LAYER2 48 GREEN	000-255	Green intensity	Layer 2 Green	
243	239	/	FLASH 60 BLUE	LAYER2 48 BLUE	000-255	Blue intensity	Layer 2 Blue	
244	240	/	FLASH 60 WHITE	LAYER2 48 WHITE	000-255	White intensity	Layer 2 White	
245	/	5	CCT		000-255	Color Temperature		
246	/	6	TINT		000-255			
247	/	7	BG DIMMER		000-255	Strobe Dimmer		
248	/	8	BG STROBE		000-030	No flash/Closed		
					031-100	Strobe slow to fast		
					101-130	Open		
					131-200	Random strobe slow to fast		
					201-255	Open		
249	/	9	BG RED		000-255	Red intensity		
250	/	10	BG GREEN		000-255	Green intensity		
251	/	11	BG BLUE		000-255	Blue intensity		
252	/	12	BG WHITE		000-255	White intensity		
253	/	13	LAYER1 DIMMER		000-255	Strobe Dimmer		
254	/	14	LAYER1 STROBE		000-030	No flash/Closed		
					031-100	Strobe slow to fast		
					101-130	Open		
					131-200	Random strobe slow to fast		
					201-255	Open		
255	/	15	LAYER1 RED		000-255	Red intensity		
256	/	16	LAYER1 GREEN		000-255	Green intensity		
257	/	17	LAYER1 BLUE		000-255	Blue intensity		
258	/	18	LAYER1 WHITE		000-255	White intensity		

259	/	19	LAYER1 FX	000-010	No Function	
				011-015	FX 1	
				016-020	FX 2	
				021-025	FX 3	
				026-030	FX 4	
				031-035	FX 5	
				036-040	FX 6	
				041-045	FX 7	
				046-050	FX 8	
				051-055	FX 9	
				056-060	FX 10	
				061-065	FX 11	
				066-070	FX 12	
				071-075	FX 13	
				076-080	FX 14	
				081-085	FX 15	
				086-090	FX 16	
				091-095	FX 17	
				096-100	FX 18	
				101-105	FX 19	
				106-110	FX 20	
				111-115	FX 21	
				116-120	FX 22	
121-125	FX 23					
126-205	RESERVED(TBD)					
206-255	Random pixel(with density)	From 1 to 10 pixel, 1 more pixel every 5 steps				
260	/	20	LAYER1 FX SPEED	000-050	Static indexing	
				051-255	From slow to fast	
261	/	21	LAYER1 FX OFFSET	000-200	Continuous start selection	Choose the step of start
				201-255	Random distribution	Enables an internal distribution of the macro between a multitude of lights on a specific DMX line basing on their DMX starting address.

262	/	22	LAYER2 FX	000-010	No Function	
			(Colors and strobe are controlled by FLASH channels.	011-015	FX 1	
			If no FX is selected, the FLASH channels will works as basic function.)	016-020	FX 2	
				021-025	FX 3	
				026-030	FX 4	
				031-035	FX 5	
				036-040	FX 6	
				041-045	FX 7	
				046-050	FX 8	
				051-055	FX 9	
				056-060	FX 10	
				061-065	FX 11	
				066-070	FX 12	
				071-075	FX 13	
				076-080	FX 14	
				081-085	FX 15	
				086-090	FX 16	
				091-095	FX 17	
				096-100	FX 18	
				101-105	FX 19	
				106-110	FX 20	
				111-115	FX 21	
				116-120	FX 22	
	121-125	FX 23				
	126-205	RESERVED(TBD)				
	206-255	Random pixel(with density)	From 1 to 10 pixel, 1 more pixel every 5 steps			
263	/	23	LAYER2 FX SPEED	000-050	Static indexing	
				051-255	From slow to fast	
264	/	24	LAYER2 FX OFFSET	000 -200	Continuous start selection	Choose the step of start
				201 -255	Random distribution	Enables an internal distribution of the macro between a multitude of lights on a specific DMX line basing on their DMX starting address.
265	/	25	EMPTY	-	TBD	
266	/	26	EMPTY	-	TBD	
267	/	27	DIMMER MODE	000-042	From MENU	
				043-085	Mode OFF	
				086-128	Mode 1	
				129-171	Mode 2	
				172-214	Mode 3	
				215-255	Mode Auto	

Color Temperature	
000-005	No Function
006-018	2800K
019-031	3000K
032-044	3200K
045-057	3500K
058-070	4000K
071-083	4500K
084-096	5000K
097-109	5600K
110-122	6000K
123-135	6500K
136-148	7000K
149-161	7500K
162-174	8000K
175-187	8500K
188-200	9000K
201-213	9500K
214-226	10000K
227-255	No Function

TINT			
Function	8 bit value		Note
	From	To	
-25% to 0	0	127	Default @ 128
Neutral	128	128	Linear Tint correction from -0.25 to +0.25
0 to 25%	129	255	

8.TROUBLESHOOTING

Trouble	Reason	Solution
no menu display	1. No AC input	1. check the power circuit
	2. power supply unit failure	2. check the PSU if there is voltage output
	3. Display malfunction	3. replace display pcb
No DMX signal	1. DMX cable malfunction	1. Check or replace the signal cable.
	2. Incorrect wiring sequence of the signal cable	2. Check the signal cable wiring sequence.
	3. IC is damaged on input terminal	3. Check whether the IC and the two resistorson the signal cableis open circuit or not
	4. DMX address code setting does not match the control on the console	4. Check or reset the address code or restore the device to factory settings and retest.
	5. Other parameter settings are incorrect	
	6. After entering the menu, you did not press the confirm key or the MENU key to exit to the main menu.	5. Press MENU to exit to the main menu.
temperature control protection cannot be performed when surface temperature exceeds 75°	1. Thermistor on the LED board is faulty.	1. Replace the thermistor
	2. The temperature control circuit on the display board is faulty.	2. Check the temperature control circuit on the mainboard
Uneven color mixing and uneven light spots	1. The LED is not soldered correctly.	1. Check the LED soldering.
	2. The lens or bracket is not properly installed.	2. Check the lens assembly process and adjust the bracket.
color cast (reddish, greenish or bluish)	1. The LED current for one LED group is too high or too low.	1. Check the driving current of the corresponding LED group on the driver board.
	2. The white balance of RGBW color mixing is incorrectly set.	2. Reset or restore to factory settings.
		3. Replace the related IC.
Led does not light up or flickers	The LED is damaged or the driver board has no current output	1. Replace the LED bulb.
		2. Replace the damaged LED or check the driver board circuit.
		3. Replace the related IC.
Parameters can not be saved	IC to save parameters is damaged	Replace the related IC.
The fixture does not work after powered on	When the temperature is too high, over-temperature protection causes power supply unit not working	wait until the fixture cools down before restarting.

9. MAINTENANCE

Make sure the area below the installation place is free from unwanted persons during setup

- Switch off the unit, unplug the main cable and wait until the unit has cooled down. All screws used for installing the device and any of its parts should be tightly fastened and should not be corroded.
- Housings, Fixations and installation spots (ceiling, trusses, suspensions) should be totally free from any deformation.
- The main cables must be in impeccable condition and should be replaced immediately even when a small problem is detected.
- It is recommended to clean the front at regular intervals, from impurities caused by dust, smoke, or other particles to ensure that the light is radiated at maximum brightness. For cleaning, disconnect the main plug from the socket. Use a soft, clean cloth moistened with a mild detergent. Then carefully wipe the part dry. For cleaning other housing parts use only a soft, clean cloth. Never use a liquid, it might penetrate the unit and cause damage to it.

10. EXPLODE DIAGRAM

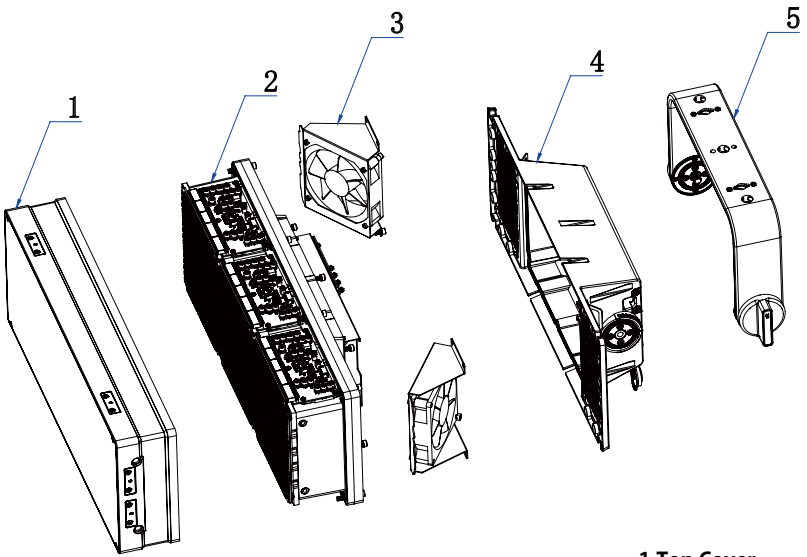

- 1.Top Cover
- 2.Main body
- 3.Fan
- 4.Back Cover
- 5.Bracket



EKINC.

Address: NO.55 Zhongzhun Road, Cuiheng New District, Zhongshan City, Guangdong Province

Phone: 0086 (0760) 88280099

www.eklights.com